

DESCRIPTION

The TS-690BS-AS is a Booster unit used to connect between the conference system's Central unit (TS-690-AS) and Conference units (TS-691L-AS Chairman unit and TS-692L-AS Delegate unit). The Booster unit permits up to 30 Conference units can be connected to the Central unit.

SPECIFICATIONS

Power Source	36V DC (supplied from the Central Unit TS-690-AS)
Current Consumption	Max. 10mA
Connection Terminal	Connect to Central unit: Cable length 2m with 8 pins DIN plug Connect to Conference units: 8 pins DIN Socket x 2
LED Indicator	Power status indicator
Number of Connectable Conference units	Max. 30 units
Operating Temperature	0 °C to +40 °C (32 °F to 104 °F)
Operating Humidity	90 %RH or less (no condensation)
Finish	Steel plate, black, 30% gloss, paint
Dimensions	90 (W) x 37 (H) x 97.5 (D) mm (3.54" x 1.46" x 3.84")
Weight	450 g (1.00 lb)

APPEARANCE

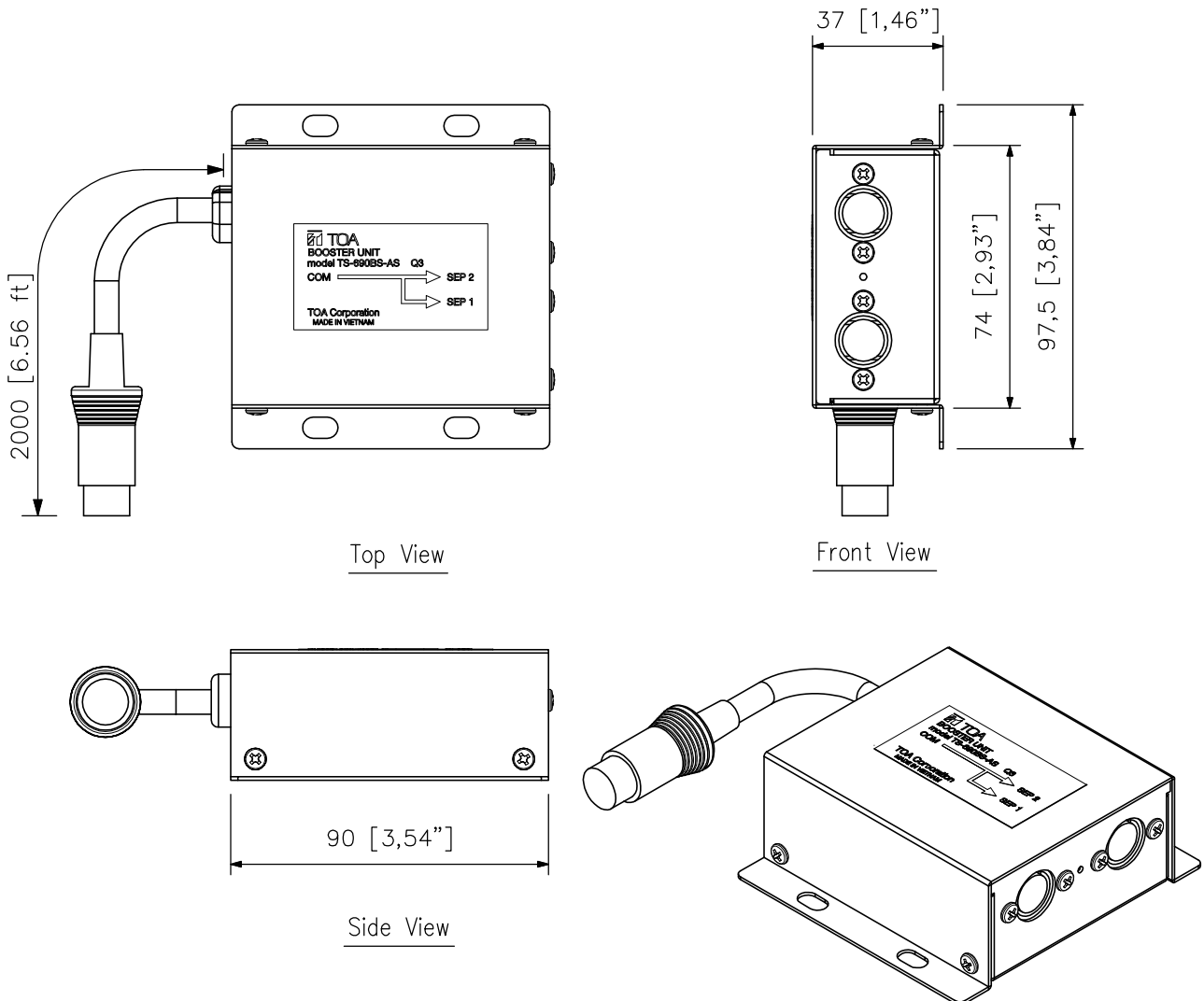

UNIT: mm SCALE: 1/2